

PROJECT HIGHLIGHTS

Live the best of life with the best of amenities.

-  **Grandeur Arch**
-  **Beautiful Landscape**
-  **Compound wall with Solar Fencing**
-  **CC Roads**
-  **Open Gym**
-  **24x7 Security with CCTV Surveillance**
-  **Cycling & Jogging Track**
-  **Children's Play Area**
-  **Amphitheatre**

LOCATION HIGHLIGHTS

Live a premium lifestyle at the most accessible & affordable location



A PROJECT BY



A STEP CLOSER TO NATURE



545 PREMIUM VILLA PLOTS | STARTING FROM 165 SQUARE YARDS
@CHEGUNTA

BOOKINGS OPEN

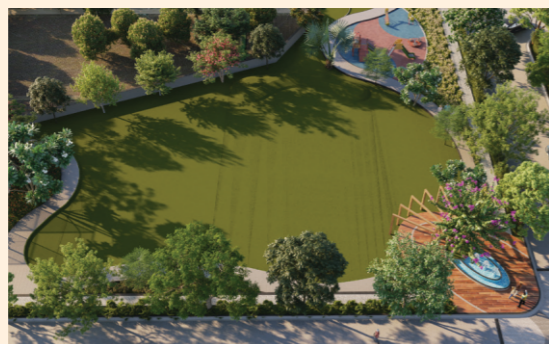

A PROJECT BY



Office : Plot No: 8A H.NO: 06-264/13/1/8P/B,
Raghavendra Colony,
Beside Indian Oil Petrol Pump Lane,
Suchitra, Hyderabad - 55.

info@srislnproperties.com | www.srislnproperties.com |   



SRI SLN PROPERTIES

APPROVED BY
DTCP

TLP No. 258/2022/H



Reg. No. P01000005338

SHAANTHAM
MEADOWS
A STEP CLOSER TO NATURE

A PROJECT BY
ITHIKA GROUP

LAYOUT PLAN

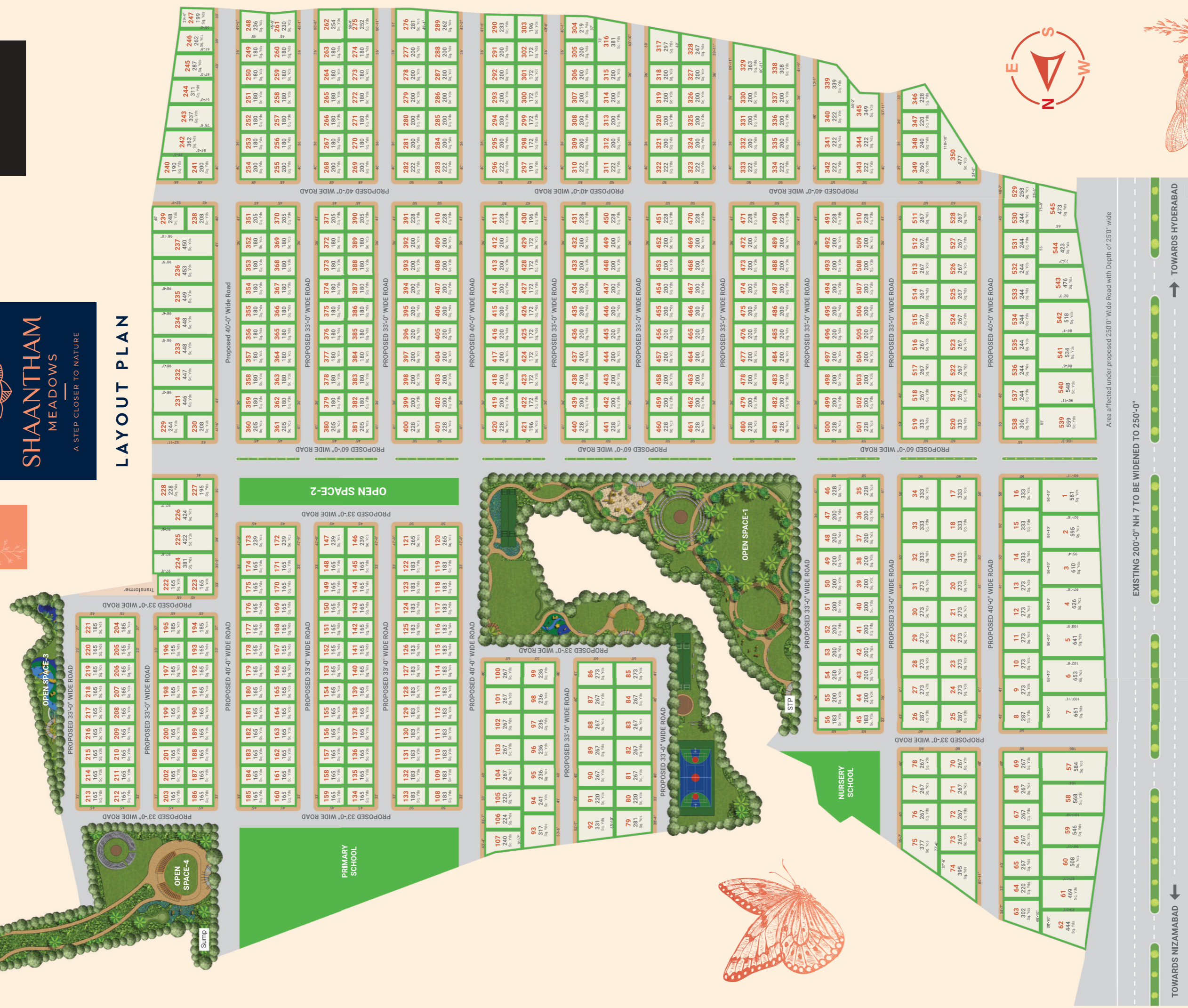

Area affected under proposed 2500' Wide Road with Depth of 250' wide
EXISTING 200'-0" NH 7 TO BE WIDENED TO 250'-0"
TOWARDS NIZAMABAD ←
TOWARDS HYDERABAD →

CHEGUNTA MAIN ROAD

